

# 400258 INSTALLATION INSTRUCTIONS

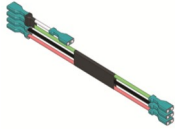

**1 INSURE RECEIPT OF NECESSARY PARTS**



WIRE HARNESS

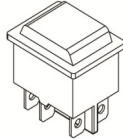

ROCKER SWITCH



2X 4mm SCREWS

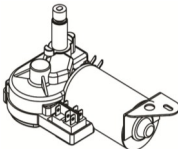

Y-MOTOR

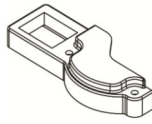

MOTOR BRACKET

**2 INSTALL BRACKET AS SHOWN**

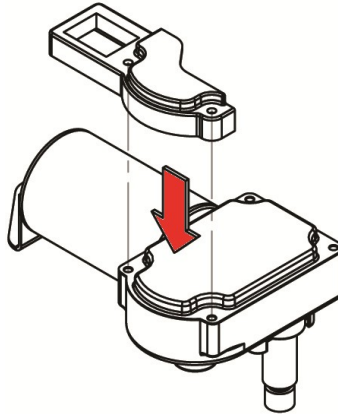

USE 4mm SCREWS TO SECURE BRACKET

**3 INSTALL SWITCH AS SHOWN**

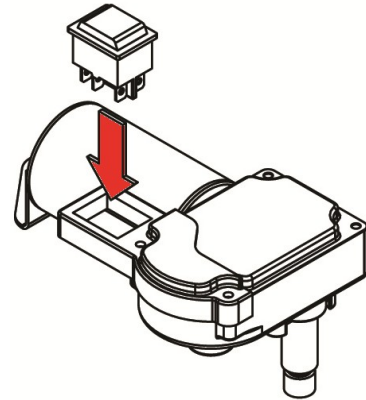

SWITCH SNAPS INTO PLACE

**4 WIRE ROCKER SWITCH AS SHOWN**

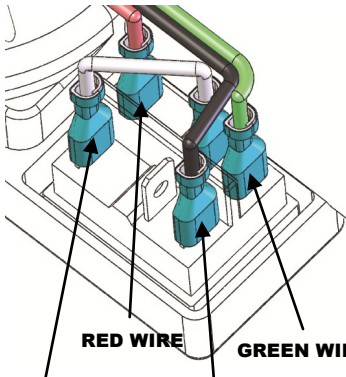

RED WIRE GREEN WIRE  
WHITE WIRE BLACK WIRE

**5 WIRE MOTOR TERMINALS AS SHOWN**

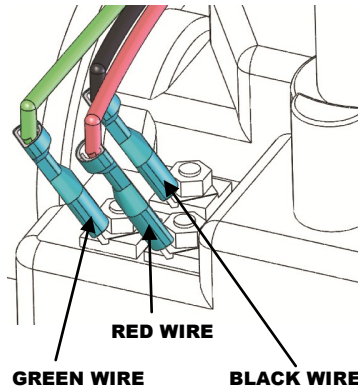

RED WIRE  
GREEN WIRE BLACK WIRE

**6 CONNECT SWITCH TO B+**

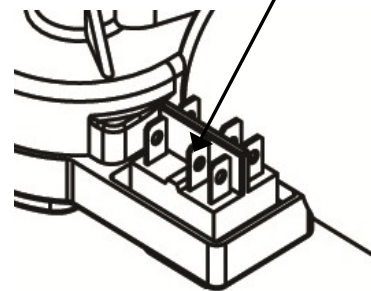

GROUND MOTOR HOUSING TO VEHICLE CHASSIS

**7**

## INCORRECT

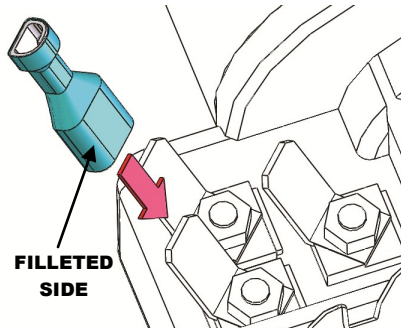

FILLETED SIDE

## CORRECT

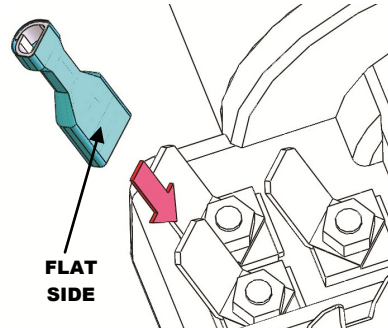

FLAT SIDE