

REV	DATE	ECR	DESCRIPTION
0	1-31-18	-	Release for prototype

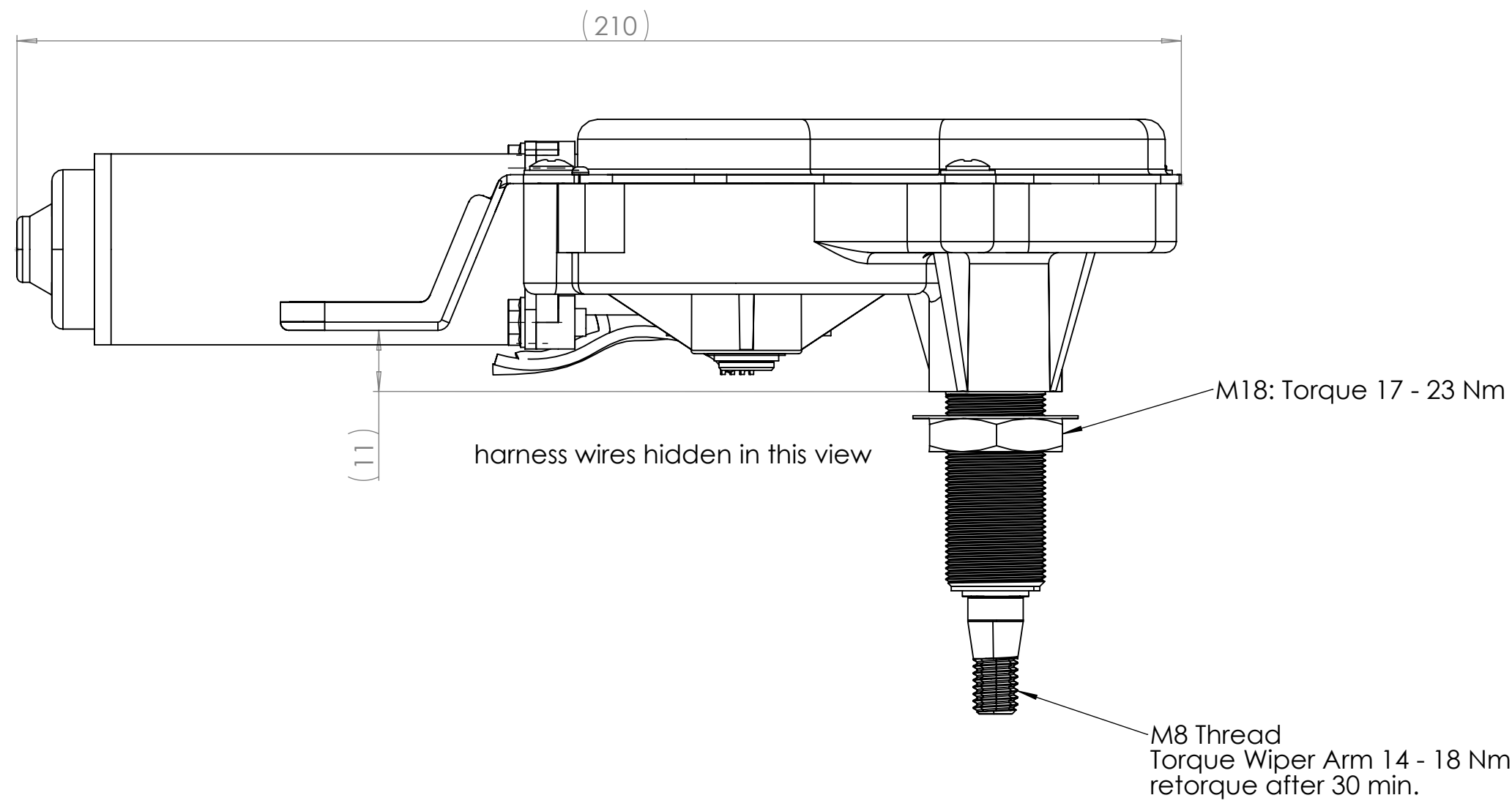

- Notes
1. motor suitable for panel thickness up to 7 mm
  2. supplied with M18 nut and washer loose
  3. supports arm and blade lengths up to 16"x16"
  4. stall torque: 9 Nm at worm gear,
  5. stall current: 14A max.
  6. wipe angle: 160°, 13.5V, no load
  7. motor is thermoswitch protected
  9. no load speed: 43±5
  10. no load current: 1A
  11. supplied without electrical connector

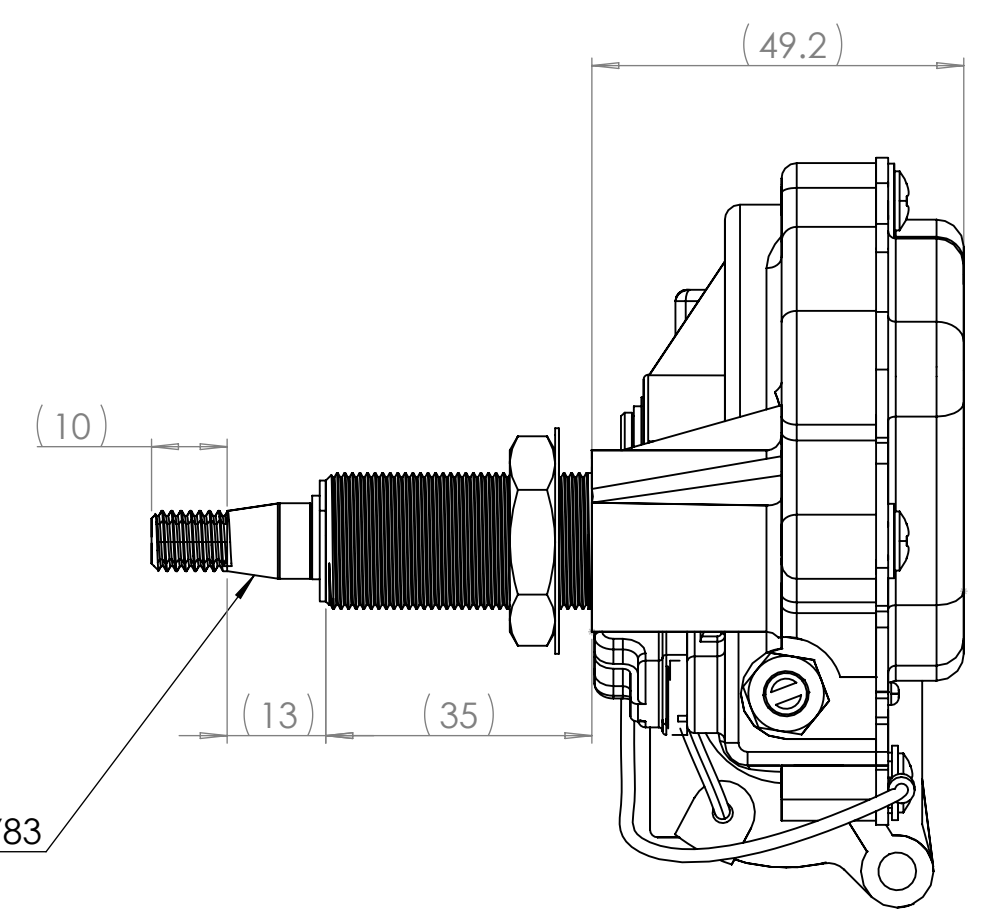
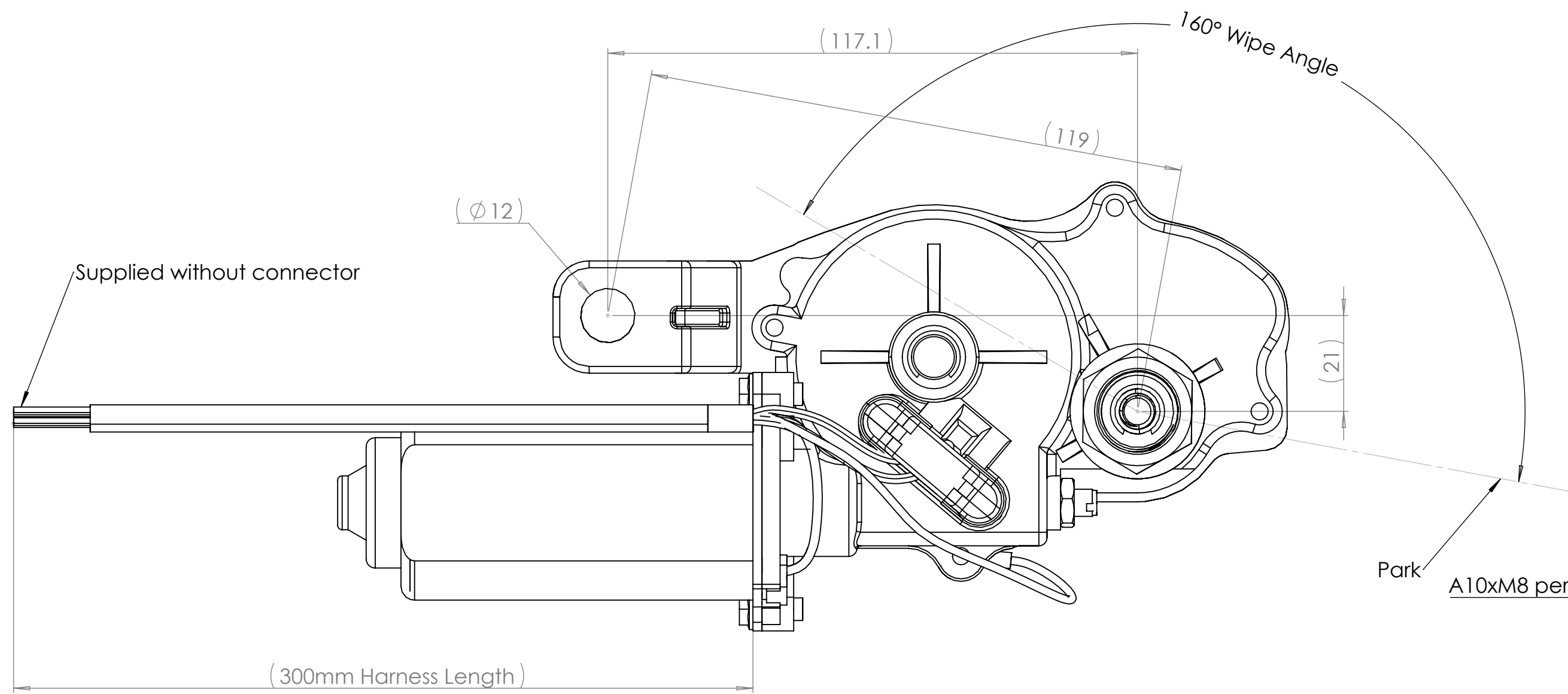
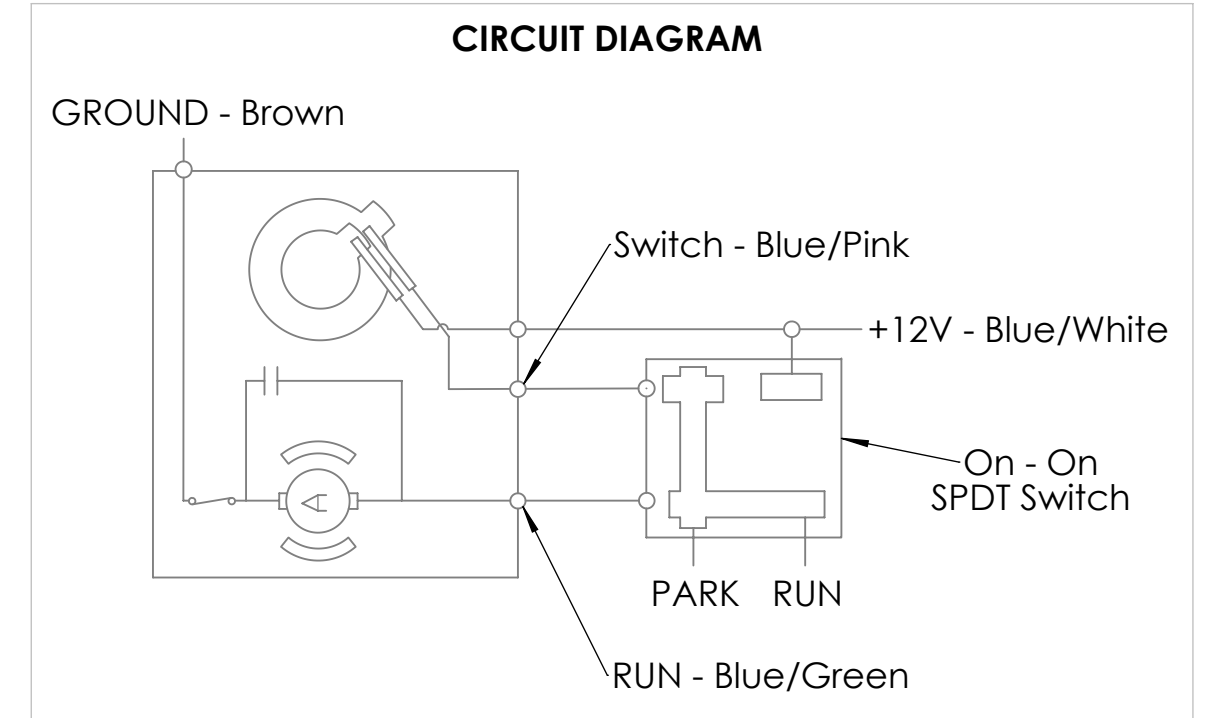

**PROPRIETARY AND CONFIDENTIAL**  
THE INFORMATION CONTAINED IN THIS DRAWING IS THE SOLE PROPERTY OF WEXCO INDUSTRIES. ANY REPRODUCTION IN PART OR AS A WHOLE WITHOUT THE WRITTEN PERMISSION OF WEXCO INDUSTRIES IS PROHIBITED.

UNLESS OTHERWISE SPECIFIED:		NAME	DATE
DIMENSIONS ARE IN MM	DRAWN	JH	1-31-18
3rd ANGLE PROJECTION	CHECKED	MP	1-31-18
	ENG APPR.	JH	1-31-18
INTERPRET GEOMETRIC TOLERANCING PER: ISO 2768-1 M MATERIAL	COMMENTS:		
FINISH			
APPLICATION			

**WEXCO INDUSTRIES**

TITLE:  
**160° Single Speed Motor**

SIZE	DWG. NO.	REV
<b>C</b>	4712.R160.E1	0

SCALE: 1:2 WEIGHT: SHEET 1 OF 1